

## VPL Series Vertical Pick and Place Linear Motor Modules

- *High speed high acceleration*
- *Fast response and quick settling time*
- *Compact*
- *No backlash*



## VPL32 / VPL48 / VPL51 Series

- Direct drive and direct measurement
- Fast response and quick settling time
- Zero cogging ironless linear motor
- No backlash
- Choice of encoder resolutions of up to 0.1 $\mu$ m
- Integrated reference mark and two limit sensors
- High precision Rexroth corrosion resistant linear guide with 2 high precision Rexroth runner blocks
- Compact, light and easily integrated

### Datasheet

Specifications Model	Effective stroke (mm)	Moving mass (kg)	Recommended load (kg)	Total mass (kg)	Continuous force at 75°C (N)	Peak force (N)
VPL32-S2	50.0	0.25	0.5	1.3	22.0	88.0
VPL48-S2	50.0	0.60	3.0	2.6	72.0	288.0
VPL51-S2	50.0	0.75	5.0	5.1	112.0	448.0

### Dimensional Drawing

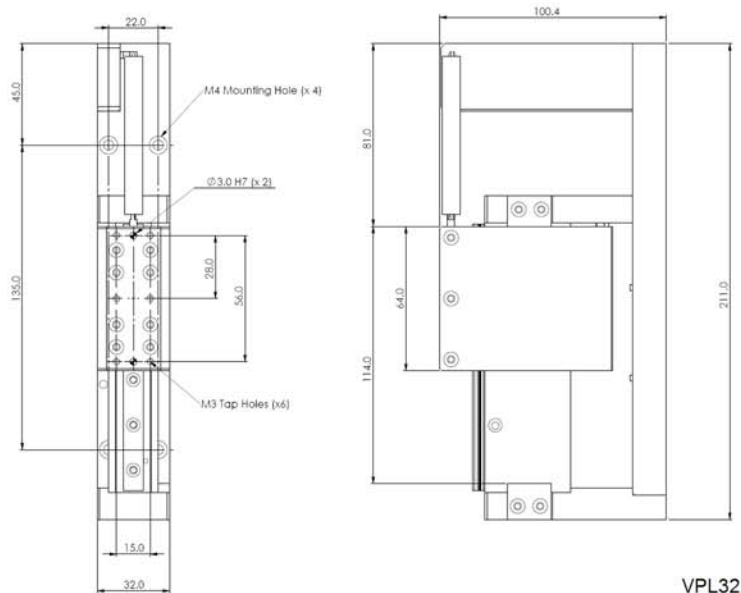

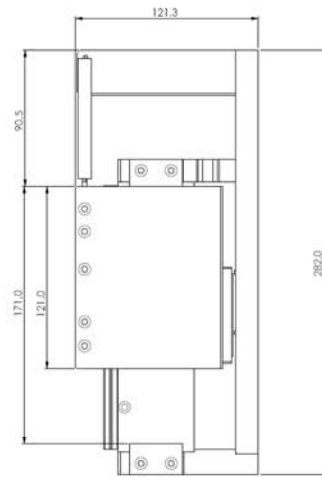
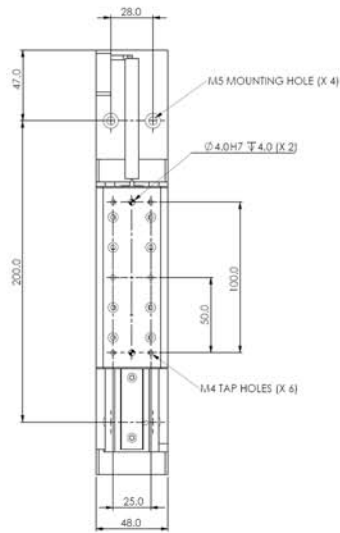

VPL48

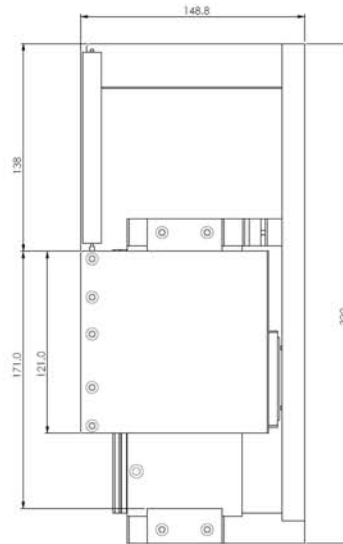
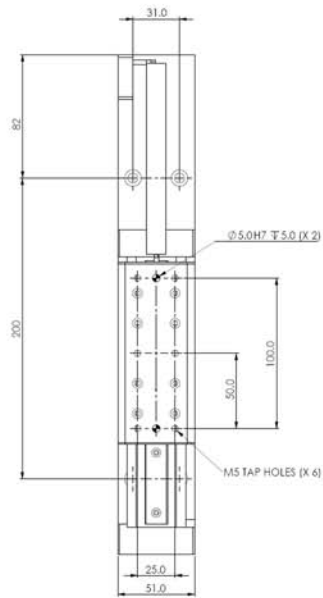

VPL51

### Part Numbering

	Size	Motor size (type)	Effective stroke (mm)	Encoder resolution ( $\mu\text{m}$ )	<sup>1</sup> Mass (kg)
VPL	32, 48, or 51	S2	50	1.0, 0.1	0.5, 2.0, or 5.0

**Example : VPL32-S2-50-1.0-0.5**

### Matching Drivers / Amplifiers

**DDP21, DDP51, ADL43**

<sup>1</sup> 0.5 = for VPL32 only  
 2.0 = for VPL48 only  
 5.0 = for VPL51 only